

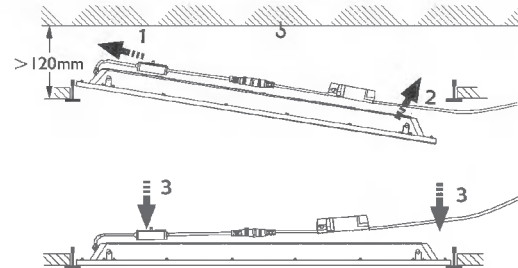

Mounting of the panel in the ceiling

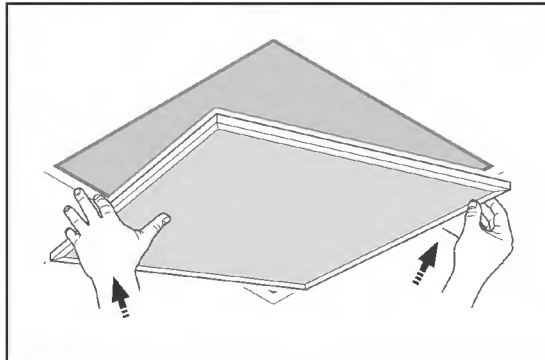

Adjust LED Panel position to fit inside the false ceiling well.

Fixation of the optional safety cables (not included)

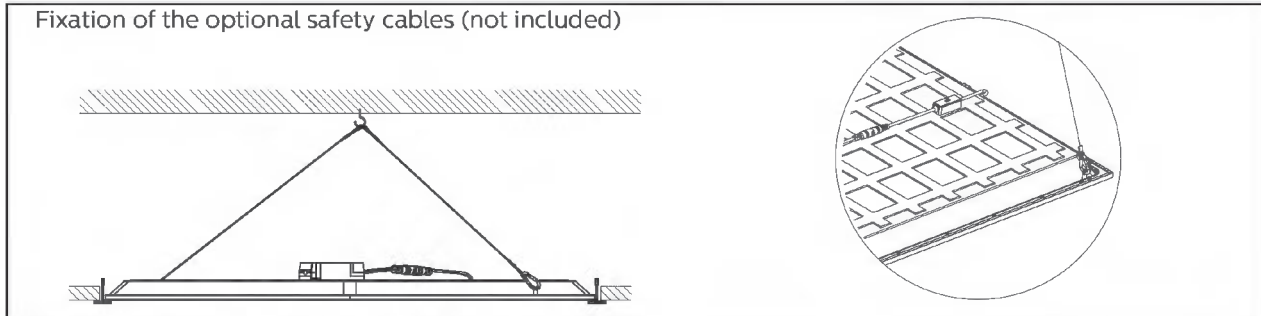

Connection of the driver

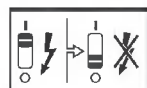

Mains-Voltage

SELV
U_{out} = 60V

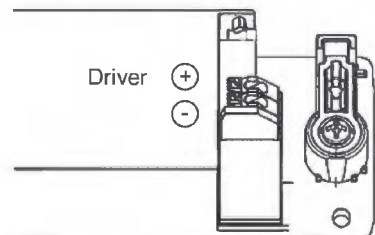

Panel cable must be attached with strain relief protection
The LED panel must not be connected or disconnected with live drivers (220-240V mains on)

Dipswitch



Red: +

Black: -



Warning

Please read these instructions carefully before attempting to install this product.

- Please follow this installation guide strictly.
- The module can only be installed into a ceiling that is perfectly horizontal and is safely suspended to a carrying structure.
- LED Panel shall only be installed or replaced by a qualified electrician and connected in accordance with latest IEEE electrical regulations or national requirements.
- If the external flexible cord of this module is damaged, it shall be exclusively replaced by the manufacturer or his service agent or a similar qualified person in order to avoid a hazard.
- The supply cord and cable provided with the module is intended for indoor use only.
- LED Panel is intended for indoor use only.
- The light source of this luminaire is not replaceable; when the light source reaches its end of life the whole luminaire shall be replaced.
- Safety cable connection with the hook is recommended for safety purposes only. The hook cannot be used for suspending the module
- This product is designed for installation on a T-bar ceiling system only
- The luminaire is not suitable for covering with thermally insulating material.